

ASSEMBLY INSTRUCTIONS

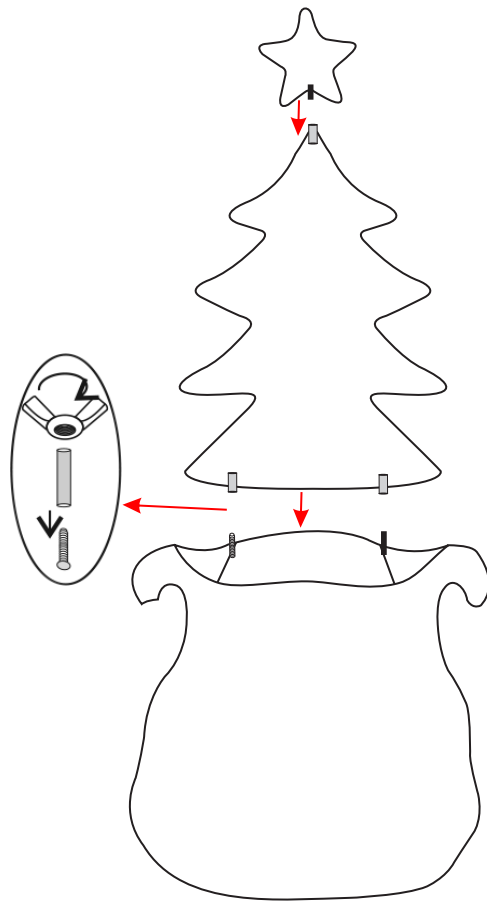

Insert the screw and rod for the tree and gift bag and tighten with the wingnut supplied.

Attach the star rod into the tree tube as shown.

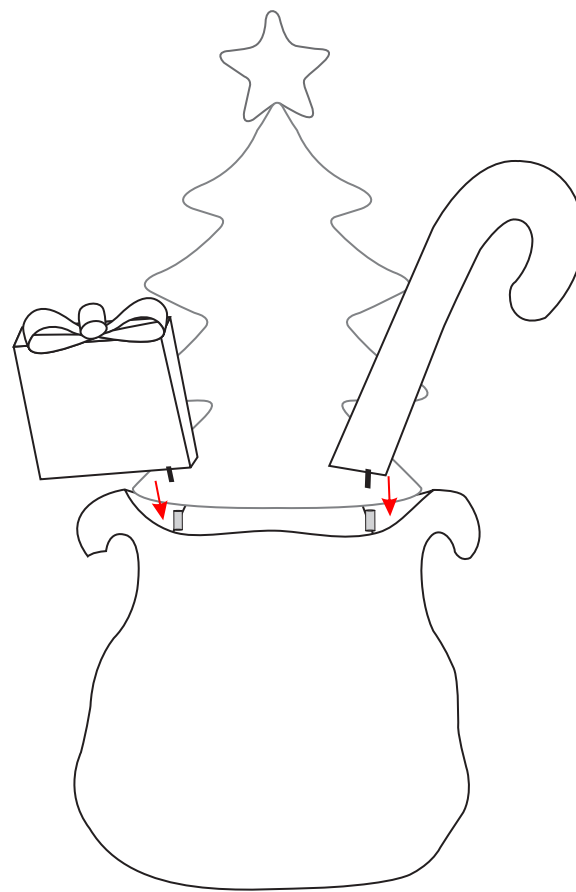

Attach the gift box and candy cane by inserting the rods into the tubes as shown. Use supplied zip ties to secure.

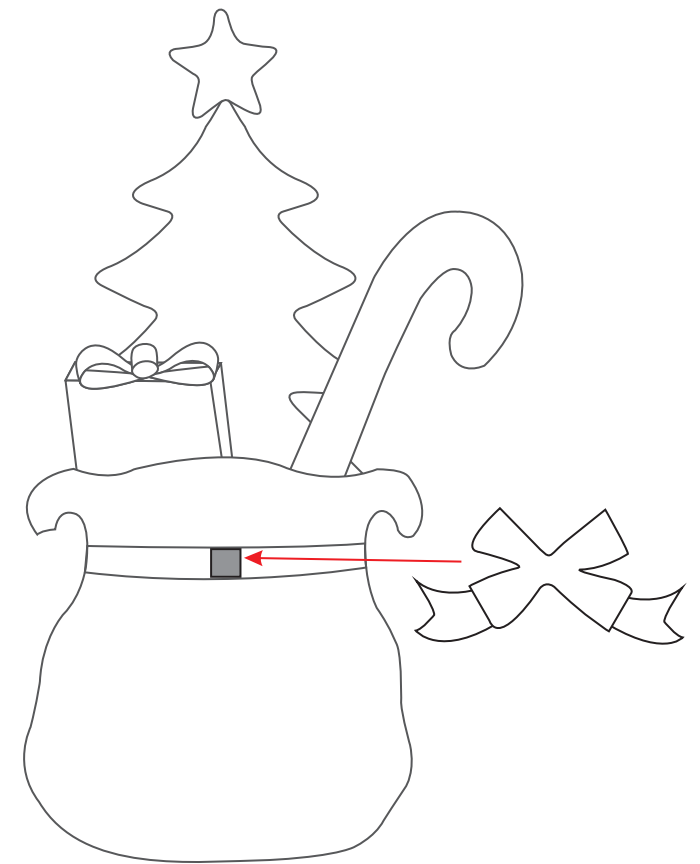

Attach the bow to the front of the gift bag.